



*Offering
a complete line
of material handling
equipment.*

Bucket Elevators & Conveyors



**"Your Complete
Systems
Manufacturer."**

GSI Bucket Elevator Heads

GSI's line of bucket elevators are highly corrosion resistant and made standard with a powder coat finish for lasting durability and superior appearance.

(Also available in galvanized construction up to 20,000 BPH)



Other elevator head features include...

- Two piece hood for interior accessibility.
- Full radius contoured hood to minimize wear and improve material discharge flow.
- Pressure relief panels and large service doors are located on both sides of the hood.
- Machined, UHMW shaft seals.
- Heavy duty crowned face double disc drum pulley with SOFR (static conductive, oil resistant & fire retardant) lagging.
- Weather tight internal lip seal between head housing and hood to eliminate moisture problems.
- Bearing plates with vertical jack bolts for final installation alignment.
- Fully adjustable throat plate.
- Hinged pulley lagging service doors on both sides of the head housing.



Hinged service doors located on both sides of the head section provide convenient access. Doors are weather tight and flush with the inside.



Heavy-duty, double row, pillow block, roller bearings mounted externally. (Optional fully split bearing shown)



GSI's bucket elevators and conveyors are engineered to perform and

built tough

to provide years of reliable service. Whether your business is industrial or agricultural, whether your requirements are for receiving or unloading, pre-processing or post processing, count on GSI for your material handling needs.

GSI Bucket Elevator Boots

Our elevator boots use a structural iron frame construction for solid support throughout the boot. All stiffeners and frames are powder coat finished before assembly for maximum corrosion resistance.

Standard Buckets



Buckets are constructed of a durable non-sparking polyethylene. Optional steel, nylon or urethane buckets also available.



Standard belt tension take-up assembly utilizes corrosion resistant ACME threaded rods.



A hinged access door and inspection window is located on both sides of the boot.



Bucket Elevator Boot Sections Include...

- Externally mounted pillow block bearings.
- Belt tension take-up screws utilizing corrosion resistant acme threaded rod.
- Machined, full length UHMW shaft seal at take-up plate bearing surface.
- One standard boot inlet provided (field installation required).
- Hinged boot inspection door on both sides.
- Heavy duty crown faced double disc drum pulley.
- Easy access cleanout doors on each end. Drop down design used on larger elevators.
- Removable panel at boot top, between trunks, can be adapted to dust collection equipment.
- Standard boot construction of heavy gauge steel and bolted structural angle iron frame with vertical stiffeners.

Optional gravity take-up shown.
(Available on 30" & 48" elevators only)





Trunking...

- 12 gauge steel construction and heavy-duty 10 gauge (3.41mm) steel with continuous butt weld seams to reduce corrosion from moisture and dust accumulation.
- Fixture welded, structural angle iron flanges are continuously welded on the outside and stitch welded on the inside.
- Maintenance friendly 10' (3048 mm) inspection section with 9' (2743.2 mm) long opening at both front and back. Front and back panels can be removed in 3' (914.4 mm) increments. The inspection door can be located in 6 different locations for ultimate flexibility.



Unique bolted cross tie design

- Durable, SOFR (static conductive, oil resistant & fire retardant) rubber belting.
- Unique bolted cross tie design provides rigidity, squareness to trunking and is independent of flange bolts.

Other Bucket Elevator Options:

- Belt alignment and speed monitors.
- Trunking pressure relief vents.
- Additional 1/4" (6.35 mm) expanded metal back urethane head housing and hood liners.
- Galvanized head service and distributor service platforms.
- Ladder and safety cage with rest platforms.
- Winged self cleaning boot pulley.
- Bolt on shovel pocket (field installed).
- Down leg boot inlet hopper (field installation required).
- Gravity take-ups with weight box available on 30" - 48" pulley models (weights not provided).
- Urethane lined head discharge transitions.

A size to fit a variety of capacity requirements!

Bucket Elevators Specifications

MODEL	BPH	CFH	MTH	PULLEY	RPM	FPM	M/S	BUCKET SIZE	BUCKET SIZE (MM)	BUCKET SPACING	BUCKET SPACING (MM)	TRUNKING SIZE	TRUNKING SIZE (MM)
15P16	1500	1875	38	16	95	423	2.15	9 x 5	228 x 127	9	228	10 x 16	254 x 406
20P16	2000	2500	51	16	95	423	2.15	9 x 5	228 x 127	7	178	10 x 16	254 x 406
25P16	2500	3125	63	16	95	423	2.15	10 x 5	254 x 127	6.5	165	10 x 16	254 x 406
30P16	3000	3750	76	16	95	423	2.15	11 x 5	279 x 127	6	153	10 x 16	254 x 406
30P24	3000	3750	76	24	73	478	2.43	10 x 6	254 x 153	8	203	10 x 16	254 x 406
40P24	4000	5000	101	24	73	478	2.43	11 x 6	279 x 153	7	178	10 x 16	254 x 406
50P24	5000	6250	127	24	73	478	2.43	11 x 6 LP	279 x 153	5.5	140	10 x 16	254 x 406
40P30	4000	5000	101	30	67	544	2.76	11 x 6	279 x 153	8	203	12 x 18	304 x 457
50P30	5000	6250	127	30	67	544	2.76	13 x 6	330 x 153	8	203	12 x 18	304 x 457
60P30	6000	7500	152	30	67	544	2.76	13 x 6 LP	330 x 153	6	153	12 x 18	304 x 457
50P36	5000	6250	127	36	64	620	3.15	12 x 6	305 x 153	8	203	12 x 18	304 x 457
60P36	6000	7500	152	36	64	620	3.15	11 x 7	279 x 178	8.5	216	12 x 18	304 x 457
70P36	7000	8750	177	36	64	620	3.15	13 x 7	330 x 178	9	228	12 x 18	304 x 457
80P36	8000	10,000	204	36	64	620	3.15	13 x 7	330 x 178	8	203	12 x 18	304 x 457
100P36	10,000	12,500	255	36	64	620	3.15	13 x 7 LP	330 x 178	6	153	12 x 18	304 x 457
80P42	8000	10,000	204	42	60	675	3.43	14 x 7	355 x 178	9	228	14 x 22	355 x 558
100P42	10,000	12,500	255	42	60	675	3.43	14 x 8	355 x 203	10	254	14 x 22	355 x 558
120P42	12,000	15,000	306	42	60	675	3.43	16 x 8	406 x 203	10	254	14 x 22	355 x 558
140P42	14,000	17,500	355	42	60	675	3.43	16 x 8	406 x 203	9	228	14 x 22	355 x 558
150P42	15,000	18,750	382	42	60	675	3.43	16 x 8 LP	406 x 203	7.5	191	14 x 22	355 x 558
140P48	14,000	17,500	355	48	56	720	3.65	16 x 8	406 x 203	9.5	241	14 x 26	355 x 660
150P48	15,000	18,750	382	48	56	720	3.65	18 x 8	457 x 203	9.5	241	14 x 26	355 x 660
160P48	16,000	20,000	405	48	56	720	3.65	18 x 8	457 x 203	9	228	14 x 26	355 x 660
200P48	20,000	25,000	510	48	56	720	3.65	20 x 8 LP	508 x 203	7.5	191	14 x 26	355 x 660
250P48	25,000	31,250	637	48	56	720	3.65	(2) 14 x 8	355 x 203	9	228	14 x 38	355 x 965
300P48	30,000	37,500	760	48	56	720	3.65	(2) 16 x 8	406 x 203	9	228	14 x 42	355 x 1066
350P48	35,000	43,750	887	48	56	720	3.65	(2) 20 x 8	508 x 203	9.5	241	14 x 50	355 x 1270
400P48	40,000	50,000	1013	48	56	720	3.65	(3) 16 x 8	406 x 203	9.5	241	14 x 60	355 x 1524
500P48	50,000	62,500	1267	48	56	720	3.65	(3) 20 x 8	508 x 203	9.5	241	16 x 72	406 x 1829
600P58	60,000	75,000	1520	48	56	720	3.65	(3) 20 x 8 LP	508 x 203	7.5	191	16 x 72	406 x 1829

Dimensions (For Single Row Bucket Elevators)

PULLEY SIZE	16	762	24	762	30	762	36	914	42	1066	48	1219
BPH	1500-3000		3000-5000		4000-6000		5000-10000		8000-15000		14000-20000	
CFH	1875-3750		3750-6250		5000-7500		6250-12500		10000-18750		17500-25000	
MTH	38-76		102-127		102-152		127-254		204-381		356-510	
A	34"	864	42"	1066	52"	1321	58"	1473	67"	1702	73"	1854
B	48"	1219	48"	1219	60"	1524	60"	1524	72"	1829	72"	1829
C	14"	356	22"	558	28"	711	34"	864	39"	991	45"	1143
D	10"	254	10"	254	12"	305	12"	305	14"	356	14"	356
E	16"	406	16"	406	18"	457	18"	457	22"	559	26"	660
F	36"	914	36"	914	48"	1219	48"	1219	60"	1524	60"	1524
G	29"	737	33"	838	42"	1067	48"	1219	60"	1524	60"	1524
H	58"	1472	66"	1676	84"	2134	96"	2438	108"	2743	120"	3048
I	65"	1651	69"	1753	90"	2286	96"	2438	120"	3048	120"	3048
J	12"	304	12"	304	14"	356	20"	508	19"	483	23"	584
K	12"	304	12"	304	18"	457	18"	457	22"	559	24"	610
L	16"	406	16"	406	18"	457	18"	457	22"	559	26"	660
M	35"	889	42"	1067	46"	1168	53"	1346	62"	1575	69"	1753
N	14"	356	16"	406	16"	406	20"	508	24"	610	28"	711
O	10"	254	10"	254	12"	305	12"	305	16"	406	18"	457
P	21"	533	26"	660	30"	762	33"	838	38"	965	41"	1041
S	30"	762	30"	762	40"	1016	40"	1016	50"	1270	62"	1575

Dimensions (For Two Row Bucket Elevators)

PULLEY SIZE	48-250	1219	48-300	1219	48-350	1219	48-400	1219	48-600	1219
BPH	25000		30000		35000		40000		60000	
CFH	31250		37500		43750		50000		75000	
MTH	637		765		893		1020		1224	
A	73"	1854	73"	1854	73"	1854	73"	1854	76"	1930
B	72"	1829	72"	1829	72"	1829	72"	1829	84"	2134
C	45"	1143	45"	1143	45"	1143	45"	1143	44"	1118
D	14"	356	14"	356	14"	356	14"	356	16"	406
E	38"	965	42"	1067	50"	1270	60"	1270	72"	1829
F	60"	1524	60"	1524	60"	1524	60"	1524	60"	1524
G	60"	1524	60"	1524	60"	1524	60"	1524	60"	1524
H	120"	3048	120"	3048	120"	3048	120"	3048	123"	3124
I	120"	3048	120"	3048	120"	3048	120"	3048	120"	3048
J	23"	584	23"	584	23"	584	23"	584	23"	584
K	24"	610	24"	610	24"	610	24"	610	24"	610
L	38"	965	42"	1067	50"	1270	60"	1270	72"	1829
M	69"	1753	69"	1753	69"	1753	69"	1753	81"	2057
N	28"	711	28"	711	28"	711	28"	711	28"	711
O	30"	762	34"	864	42"	1067	52"	1321	64"	1626
P	41"	1041	41"	1041	41"	1041	41"	1041	51"	1295
S	62"	1575	62"	1575	62"	1575	62"	1575	62"	1575

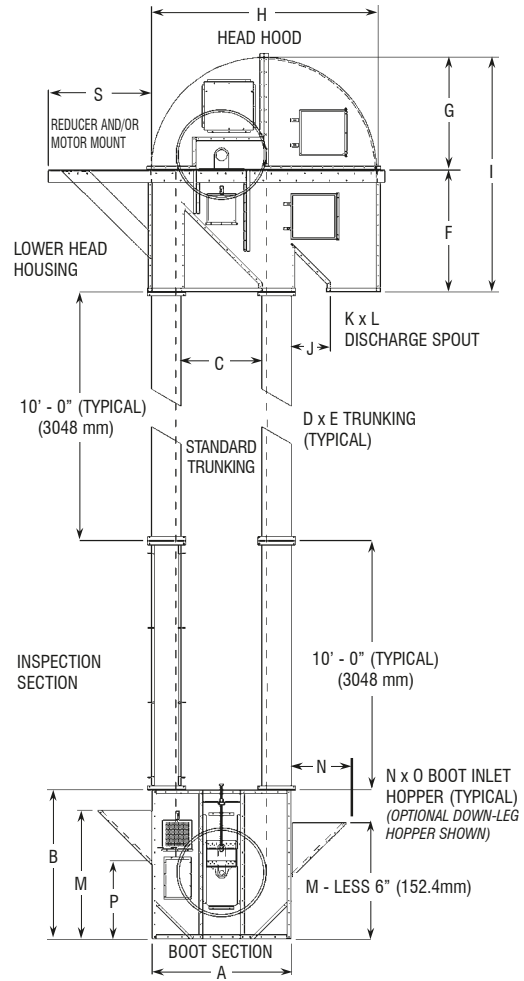

- Capacities based on dry, free flowing, granular material with proper loading and unloading conditions at 45#/CF. (721kg/m³) using conservative cup capacities per manufacturer's recommendations.
- The raw material gauge specifications refer to hot rolled steel. For galvanized steel requirements the specifications are identical, except 8 Ga. (4.26 mm) galvanized steel replaces 7 Ga. (4.55 mm) hot rolled steel.
- General specifications and dimensions are subject to change without notice.
- General specifications and dimensions are intended to provide sales assistance and preliminary guide to system layout only.

26" & 32" Tall En-Masse Conveyors

For larger grain capacity requirements, GSI offers a 26" and 32" En-Masse Conveyor. These conveyors feature an extra heavy-duty construction, easy access to all vital hardware and a powder paint coated finish for lasting durability.



En-Masse Conveyor standard features and options include...

- *Abrasion resistant steel wear liners with recessed fasteners for removal or replacement (see below).*
- *Slack chain switch.*
- *Hinged head relief door with limit switch standard.*
- *Bypass inlet hopper.*
- *Manual or electric head and intermediate discharge gates.*
- *Head and tail housing split for shaft and sprocket removal.*
- *Standard split sprockets.*
- *Conveyor support legs.*
- *Chain options available.*

* Some photos are shown with covers removed for clarity. All covers and guards should be in place prior to operation.

26" & 32" En-Masse Conveyor Capacity Chart

Size (W x H)	1 FPM	100	110	120	130	140	150	160	170	180
26 x 26	148 BPH	14800 BPH	16280 BPH	17760 BPH	19240 BPH	20720 BPH	22200 BPH	23680 BPH	25160 BPH	26640 BPH
660 x 660	3.7 MTH	379 MTH	416 MTH	454 MTH	492 MTH	530 MTH	568 MTH	606 MTH	644 MTH	682 MTH
32 x 26	182 BPH	18200 BPH	20020 BPH	21840 BPH	23660 BPH	25480 BPH	27300 BPH	29120 BPH	30940 BPH	32760 BPH
813 x 660	4.6 MTH	466 MTH	512 MTH	559 MTH	606 MTH	652 MTH	699 MTH	745 MTH	792 MTH	839 MTH
32 x 32	233 BPH	23300 BPH	25630 BPH	27960 BPH	30290 BPH	32620 BPH	34950 BPH	37280 BPH	39610 BPH	41940 BPH
813 x 813	5.9 MTH	596 MTH	656 MTH	716 MTH	775 MTH	835 MTH	895 MTH	954 MTH	1014 MTH	1074 MTH
36 x 32	262 BPH	26200 BPH	28820 BPH	31440 BPH	34060 BPH	36680 BPH	39300 BPH	41920 BPH	44540 BPH	47160 BPH
914 x 813	6.7 MTH	671 MTH	738 MTH	805 MTH	872 MTH	939 MTH	1006 MTH	1073 MTH	1140 MTH	1207 MTH

26" and 32" En-Masse Conveyor Dimensional Chart

SIZE (W X H)	A	B	C	D	E	F	G	H
26 X 26	26.00	26.00	33.50	30.00	96.00	26.00	46.00	36.00
32 X 26	32.00	26.00	39.50	30.00	96.00	26.00	46.00	36.00
32 X 32	32.00	32.00	39.50	36.00	96.00	32.00	46.00	36.00
36 X 32	36.00	32.00	43.50	36.00	96.00	32.00	46.00	36.00

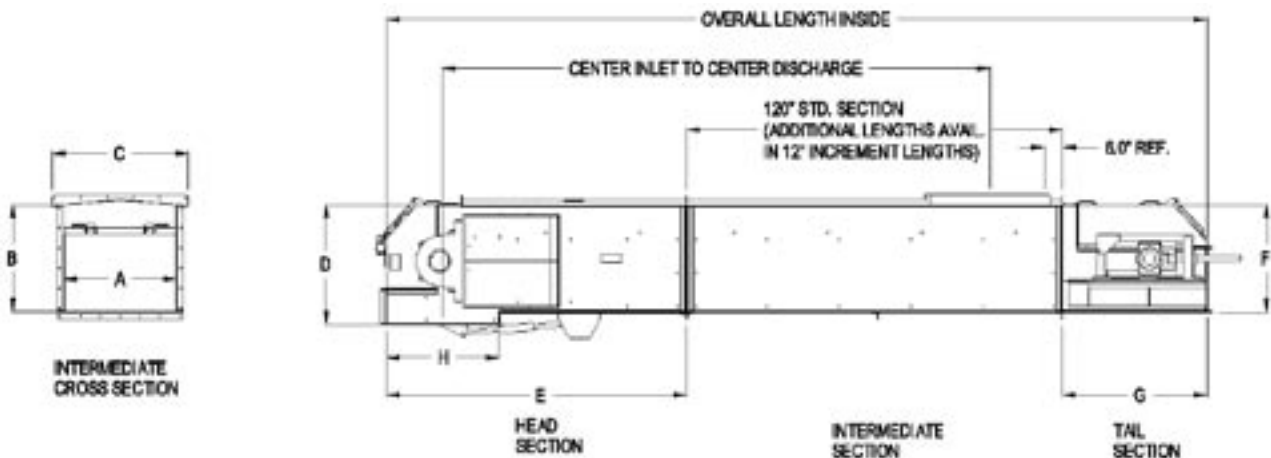

Hi-Flight Conveyors

Hi-Flight Conveyor features include:

- Capacities up to 20,000 BPH.
- Bend sections available in 15, 30, 45 and 60 degree units for conveyors requiring both a horizontal and inclined run.
- Powder coat finish standard - Galvanized construction available.
- Bypass inlets & dump hoppers.
- Head and tail housing split for shaft and sprocket removal.
- Abrasion resistant bottoms and bolted side liner packages available (see below).
- Chain assembly includes 1/2" thick UHMW paddles (3/4" thick on 36" x 27") with angle iron attachments.



Hi-Flight Conveyor Dimensional Chart

SIZE (W X H)	A	B	C	D	E	F	G	H	I	J	K	L	M	N	O
12 X 12	12.00	12.00	20.25	60.00	42.00	30.00	17.25	48.00	2.25	24.00	12.00	22.25	30.00	24.00	36.00
16 X 12	16.00	12.00	20.25	60.00	42.00	30.00	17.25	48.00	2.25	24.00	16.00	24.25	30.00	28.00	36.00
16 X 14	16.00	14.00	23.00	60.00	42.00	30.00	19.00	48.00	2.25	24.00	16.00	26.25	30.00	28.00	36.00
21 X 14	21.00	14.00	23.00	60.00	42.00	30.00	19.00	48.00	2.25	24.00	21.00	28.75	30.00	33.00	36.00
16 X 20	16.00	20.00	30.00	72.00	48.00	36.00	26.25	48.00	2.00	24.00	16.00	32.00	30.00	36.00	36.00
20 X 20	20.00	20.00	30.00	72.00	48.00	36.00	26.25	48.00	2.00	24.00	20.00	34.00	30.00	40.00	36.00
26 X 20	26.00	20.00	30.00	72.00	48.00	36.00	26.25	48.00	2.00	24.00	26.00	37.00	30.00	46.00	36.00
32 X 20	32.00	20.00	30.00	72.00	48.00	36.00	26.25	48.00	2.00	24.00	32.00	40.00	30.00	52.00	36.00
36 X 27	36.00	27.00	39.50	104.00	78.00	42.00	37.50	72.00	2.00	24.00	36.00	49.00	30.00	56.00	36.00

Bend Sections

15° Bend Section	P	Q	R
12" Tall	2.50	18.75	72.00
14" Tall	2.50	18.75	72.00
20" Tall	3.75	24.75	96.00
27" Tall	3.75	24.75	96.00

30° Bend Section	P	Q	R
12" Tall	9.75	36.00	72.00
14" Tall	9.75	36.00	72.00
20" Tall	12.75	47.50	96.00
27" Tall	12.75	47.50	96.00

45° Bend Section	P	Q	R
12" Tall	21.00	60.00	72.00
14" Tall	21.00	60.00	72.00
20" Tall	28.00	67.50	96.00
27" Tall	28.00	67.50	96.00

60° Bend Section	P	Q	R
12" Tall	36.00	62.50	72.00
14" Tall	36.00	62.50	72.00
20" Tall	48.00	83.25	96.00
27" Tall	48.00	83.25	96.00

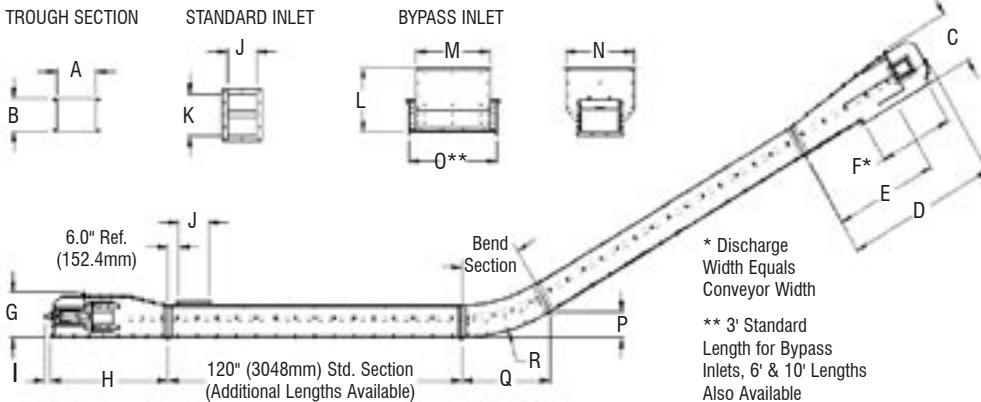

Hi-Flight Conveyor Capacities



Capacity BPH*	Conveyor Size & Speed	Conveyor Size & Speed
	Width x Height STANDARD Selection	Width x Height ALTERNATE Selection
2000	12 x 12 @ 100 FPM	NOT AVAILABLE
3000	16 x 12 @ 111 FPM	12 x 12 @ 150 FPM
4000	16 x 14 @ 125 FPM	16 x 12 @ 150 FPM
5000	21 x 14 @ 119 FPM	16 x 14 @ 150 FPM
6000	16 x 20 @ 125 FPM	21 x 14 @ 150 FPM
7000	16 x 20 @ 146 FPM	21 x 14 @ 150 FPM
8000	20 x 20 @ 133 FPM	16 x 20 @ 150 FPM
10000	26 x 20 @ 128 FPM	20 x 20 @ 150 FPM
12000	26 x 20 @ 154 FPM	NOT AVAILABLE
15000	32 x 20 @ 156 FPM	NOT AVAILABLE
20000	36 x 27 @ 140 FPM	NOT AVAILABLE

* Capacities based on free flowing grains fed through standard top load inlets. Bypass inlets will reduce capacity - consult engineering.

En-Masse & Hi-Flight Conveyors

Enclosed Belt Conveyors

Head Section...

- 16" diameter slide lagged pulley, XT Bushing and hubs, (2" wider than belt).
- 24" diameter slide lagged pulley with 10" diameter snubber pulley on longer lengths of conveyors XT bushing and hubs (2" wider than belt).
- 10 ga. reinforced housing.
- 12 ga. slide-off hood, 1/4" urethane lined front radius, door for plug switch in side of hood.
- Shafting of 1045 TG&P steel.
- Dodge Imperial 2000 series pillow block bearings with triple lip Trident seal, adapter lock collar and replaceable bearing insert, jack screws with shims for belt alignment.



Tail Section...

- 14" spiral wing type pulley with reloading rubber flippers at each end.
- Plow assembly between belts to move spilled material to side reloaders. Adjustable with replaceable skirting.
- 18", 24", 36" and 48" manual take-up w/ acme threads on take-up screws.
- Dodge Imperial 2000 series pillow block bearings with triple lip Trident seal, adapter lock collar and replaceable bearing insert, jack screws with shims for belt alignment.
- Shafting of 1045 TG&P steel.
- 3/16" thick take-up housing.
- Quick-detach or swing-up tail shroud for access to pulley (shown opposite bottom).

A re-lagging door on both sides of the head allows for easy removal and installation of the slide lags without breaking the belt.



Intermediate Section

- Anti-static UHMW bottom liners, 1/4" thick, bolted in slots to allow for thermal expansion.
- 10'-0" Intermediate sections w/ 5'-0" clamp-on covers.
- 45° Idler Rollers on 5'-0" centers w/ 1-3/8" dia. removable stub shafts, shouldered to 1-1/4" dia. for idler roller alignment.
- Dodge 1-1/4" dia. 2 bolt SC ball bearings, 207 series.
- 12 ga. housing, 26" tall with 2" flange joints.
- Inspection doors at intermediate section next to head and tail section.



Loader, Belt and Drive

- Urethane line loader (sides and rear), skirted, with matching spout angle frame.
- Pivoting UHMW skirts with stops on the conveyor with multiple inlets.
- Inspection door at the front of the loader.
- Flexco splice, 140EE, belt pre-punched at one end.
- SOR-SC-FR rubber belting with tail reloading rubber flippers at splice.
- Dodge Torque-Arm II shaft mount w/ V-belt drive, motor on reducer.
- Full width tubular torque arm restraint.

Enclosed Belt Conveyor Dimensions and Capacities

Enclosed Belt Conveyors

MODEL	A	B	C	D	E MIN	E MAX	*F	G	H	I	J	K	L	M	N	O	P	Q	R
24	26.00	30.13	47.10	120.00	47.85	65.75	76.00	5.00	6.00	24.00	14.00	18.81	15.00	30.00	27.00	26.00	30.20	43.19	38.26
30	26.00	30.13	47.10	120.00	47.85	65.75	76.00	5.00	6.00	24.00	16.00	18.81	15.00	30.00	33.00	32.00	36.20	49.19	44.26
36	26.00	30.13	47.10	120.00	47.85	65.75	76.00	5.00	6.00	24.00	22.00	18.81	15.00	30.00	39.00	38.00	42.20	55.19	50.26
42	26.00	30.13	47.10	120.00	47.85	65.75	76.00	5.00	6.00	24.00	28.00	18.81	15.00	30.00	45.00	44.00	48.20	61.19	56.26
48	26.00	30.13	47.10	120.00	47.85	65.75	76.00	5.00	6.00	24.00	34.00	18.81	15.00	30.00	51.00	50.00	54.20	67.19	62.26
54	26.00	30.13	47.10	120.00	47.85	65.75	76.00	5.00	6.00	24.00	40.00	18.81	15.00	30.00	57.00	56.00	60.20	73.19	68.26

* Based on 18.00" take-up. For actual take-up, see approval drawing.

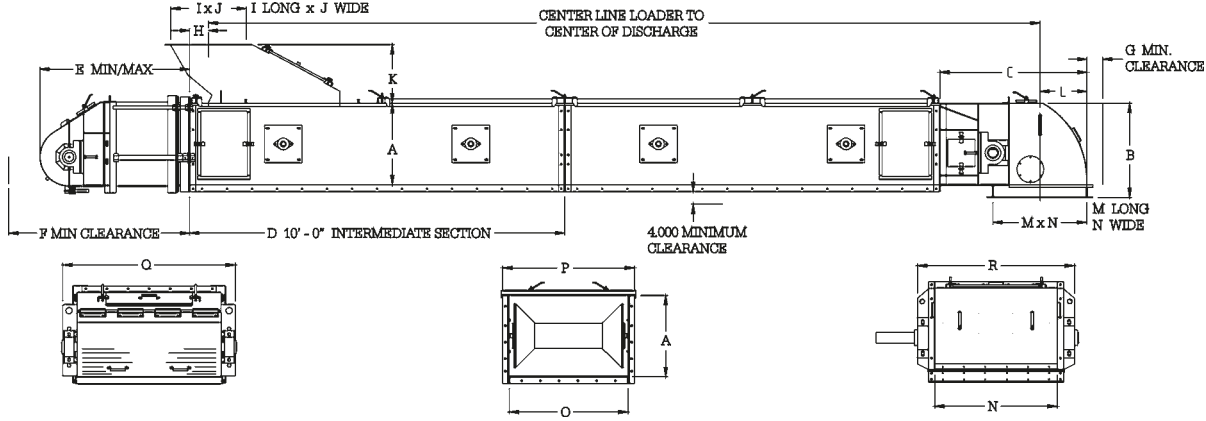

CAPACITY Bushels Per Hour										
MODEL	Belt Speed in Feet Per Minute									
	300	350	400	450	500	550	600	650	700	
24	5700	6650	7600	8550	9500	10450	11400	12350	13300	
30	9600	11200	12800	14400	16000	17600	19200	20800	22400	
36	12600	14700	16800	18900	21000	23100	25200	27300	29400	
42	16800	19600	22400	25200	28000	30800	33600	36400	39200	
48	20400	23800	27200	30600	34000	37400	40800	44200	47600	
54	24500	28500	32700	36800	41000	45000	49000	53000	57200	

CAPACITY Cubic Feet Per Hour										
MODEL	Belt Speed in Feet Per Minute									
	300	350	400	450	500	550	600	650	700	
24	7125	8313	9500	10688	11875	13063	14250	15438	16625	
30	12000	14000	16000	18000	20000	22000	24000	26000	28000	
36	15750	18375	21000	23625	26250	28875	31500	34125	36750	
42	21000	24500	28000	31500	35000	38500	42000	45500	49000	
48	25500	29750	34000	38250	42500	46750	51000	55250	59500	
54	30625	35625	40875	46000	51250	56250	61250	66250	71500	

CAPACITY Metric Tons Per Hour										
MODEL	Belt Speed in Feet Per Minute									
	300	350	400	450	500	550	600	650	700	
24	146	170	194	219	243	267	291	316	340	
30	245	286	327	368	409	450	491	532	573	
36	322	376	430	483	537	591	644	698	752	
42	430	501	573	644	716	788	859	931	1002	
48	522	609	695	782	869	956	1043	1130	1217	
54	626	729	836	941	1048	1150	1253	1355	1462	

Capacities based on dry, free flowing, granular material at 45 Lbs/CF (721 Kg/CM)

Quick Detach Tail Cover



12", 14", 20" Tall En-Masse Conveyors

GSI manufactures a complete line of En-Masse conveyors designed and engineered to minimize the length of delivery time. Our 12", 14", and 20" En-Masse conveyors offer many features to maximize performance and reduce operation costs.

Tail Section...

- Extended mount **flange bearings on 12" (304.8) and 14" (355.6 mm) tall conveyors. External mount pillow block bearings on 20" (508 mm) tall** conveyors.
- Heavy duty chain tension take-up system utilizing corrosion resistant acme threaded screws.
- Flame cut hardened steel sprockets.
- Maintenance friendly, bolted access to allow removal of the shaft, sprocket, and bearings as an assembly.
- 10 gauge housing on 12" and 14" conveyors, 7 gauge on 20" conveyors.



Head Section...

- Extended mount **flange bearings on 12" (304.8 mm) and 14" (355.6 mm) tall conveyors. External mount pillow block bearings on 20" (508 mm) tall** conveyors.
- Machined 1/4" (6.35 mm) thick UHMW shaft seals.
- Flame cut hardened steel sprockets.
- Maintenance friendly, bolted access to allow removal of the shaft, sprocket, and bearings as an assembly.
- 10 gauge housing on 12" and 14" conveyors, 7 gauge on 20" conveyors.
- Head shafts are turned ground and polished.

Intermediate Trough Sections

Conveyors are highly corrosion resistant and come standard with a powder coat finish for lasting durability and superior appearance. (Also available in galvanized construction.)



Trough Section Features...

- Dust and weather tight, heavy gauge, peaked covers on head, tail and trough.
- Bolted removable bottom construction.
- Standard 10 Ga. trough sides.
- Trough sections are fixture assembled for accurate alignment and ease of installation.
- Trough sections are flanged with structural angle to provide rigidity and accurate alignment.
- Standard roller chain engineered for each specific conveyor to maximize working load and expected life.
- UHMW flights prevent steel to steel contact.

- UHMW return rollers with shafts bolted to trough for easy maintenance and replacement.
- Rail returns are standard on 20"x 20", 26"x 20" and 32"x 20" conveyors. Rails are lined with 1/4" abrasion resistant steel and tapered end to end to minimize flight wear and maximize cleaning. Rails overlap at flange connections for smooth operation.



En-Masse Conveyor Capacity Chart

En-Masse Conveyors

Size (W x H)		1 FPM 0.005 M/S	98 FPM 0.50 M/S	118 FPM 0.60 M/S	128 FPM 0.65 M/S	138 FPM 0.70 M/S	148 FPM 0.75 M/S	157 FPM 0.80 M/S	167 FPM 0.85 M/S	177 FPM 0.90 M/S
9 x 12	BPH	21	2058	2478	2688	2898	3108	3297	3507	3717
	CFH	26.25	2572	3097	3360	3622	3885	4121	4384	4646
228 x 304	MTH	.536	52	63	68	74	79	84	89	95
12 x 12	BPH	28	2744	3304	3584	3864	4144	4396	4676	4956
	CFH	35	3430	4130	4480	4830	5180	5495	5845	6195
304 x 304	MTH	.714	70	84	91	98	105	112	119	126
16 x 12	BPH	37	3626	4366	4736	5106	5476	5809	6179	6549
	CFH	46.25	4532	5457	5920	6382	6845	7261	7723	8186
406 x 304	MTH	.943	92	111	121	130	140	148	158	167
12 x 14	BPH	34	3332	4012	4352	4692	5032	5338	5678	6018
	CFH	42.5	4165	5015	5440	5865	6290	6672	7097	7522
304 x 355	MTH	.867	85	102	111	120	128	136	145	153
16 x 14	BPH	45	4410	5310	5760	6210	6660	7065	7515	7965
	CFH	56.25	5512	6637	7200	7762	8325	8831	9393	9956
406 x 355	MTH	1.148	112	135	147	158	170	180	192	203
21 x 14	BPH	59.5	5831	7021	7616	8211	8806	9341	9936	10531
	CFH	74.375	7288	8776	9520	10263	11007	11676	12420	13164
533 x 355	MTH	1.517	148	179	194	209	224	238	253	268
14 x 20	BPH	65	6370	7670	8320	8970	9620	10205	10855	11505
	CFH	81.25	7962	9587	10400	11212	12025	12756	13568	14381
355 x 508	MTH	1.658	162	195	212	229	245	260	277	293
16 x 20	BPH	74.5	7301	8791	9536	10281	11026	11696	12441	13186
	CFH	93.125	9126	10988	11920	12851	13782	14620	15551	16483
406 x 508	MTH	1.90	186	224	243	262	281	298	317	336
20 x 20	BPH	93	9114	10974	11904	12834	13764	14601	15531	16461
	CFH	116.25	11392	13717	14880	16042	17205	18251	19413	20576
508 x 508	MTH	2.372	232	280	303	327	351	372	396	420
26 x 20	BPH	121	11858	14278	15488	16698	17908	18997	20207	21417
	CFH	151.25	14822	17847	19360	20872	22385	23746	25258	26771
660 x 508	MTH	3.086	302	364	395	426	457	485	515	546
32 x 20	BPH	149	14602	17582	19072	20562	22053	23393	24883	26373
	CFH	186.25	18253	21978	23840	25703	27565	29241	31104	32966
	MTH	3.803	373	449	487	525	563	597	635	673

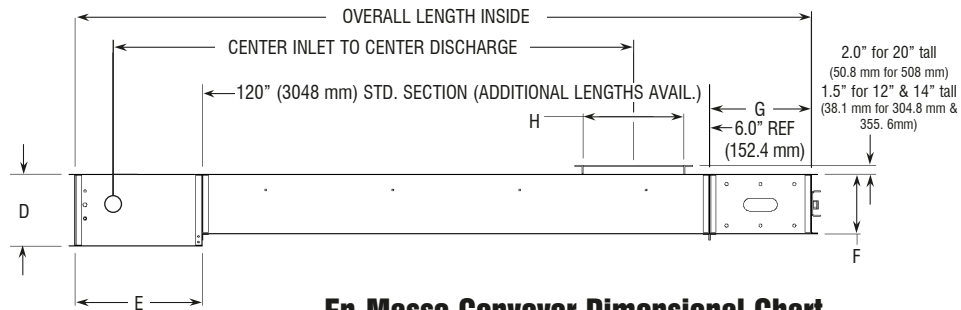
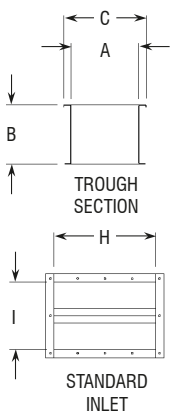

En-Masse Conveyor Dimensional Chart

Size (W x H)	A	B	C	D	E	F	G	H	I
9 x 12	9	12	12.8	15	24	12	24	24	9
228 x 304	228.6	304.8	325.1	381	609.6	304.8	609.6	609.6	228.6
12 x 12	12	12	15.8	15	24	12	24	24	12
304 x 304	304.8	304.8	401.3	381	609.6	304.8	609.6	609.6	304.8
16 x 12	16	12	19.8	15	24	12	24	24	16
406 x 304	406.4	304.8	502.9	381	609.6	304.8	609.6	609.6	406.4
12 x 14	12	14	15.8	17	30	14	24	24	12
304 x 355	304.8	355.6	401.3	431.8	762	355.6	609.6	609.6	304.8
16 x 14	16	14	19.8	17	30	14	24	24	16
406 x 355	406.4	355.6	502.9	431.8	762	355.6	609.6	609.6	406.4
21 x 14	21	14	24.8	17	30	14	24	24	21
533 x 355	533.4	355.6	630	431.8	762	355.6	609.6	609.6	533.4
14 x 20	14	20	18.8	23	36	20	30	24	14
355 x 508	355.6	508	477.5	584.2	914.4	508	762	609.6	355.6
16 x 20	16	20	20.8	23	36	20	30	24	16
406 x 508	406.4	508	528.3	584.2	914.4	508	762	609.6	406.4
20 x 20	20	20	24.8	23	36	20	30	24	20
508 x 508	508	508	630	584.2	914.4	508	762	609.6	508
26 x 20	26	20	30.8	23	36	20	30	24	26
660 x 508	660.4	508	782.3	584.2	914.4	508	762	609.6	660.4
32 x 20	32	20	36.8	23	36	20	30	24	32
813 x 508	812.8	508	934.7	584.2	914.4	508	762	609.6	812.8

General Notes:

Capacities based on dry, free flowing, granular material with proper loading and discharging conditions at 45#/CF. (721 kg/m³).

General specifications and dimensions are subject to change without notice.

General specifications and dimensions are intended to provide sales assistance and a preliminary guide to system layout only.

Farm-Com Bucket Elevators

GSI's line of FC bucket elevators are standard galvanized construction for lasting durability and superior appearance. (Up to 10,000 BPH)

Elevator Head features include...

- Two piece hood for interior accessibility.
- Full radius contoured hood to minimize wear and improve material discharge flow.
- Heavy duty crowned face double disc drum pulley with SOFR (static conductive, oil resistant & fire retardant) lagging.
- Weather tight internal lip seal between head housing and hood to eliminate moisture problems.
- Bearing plates with vertical jack bolts for final installation alignment.
- Fully adjustable throat plate.



Standard Buckets

Buckets are constructed of a durable non-sparking polyethylene. Optional steel, nylon or urethane buckets also available.

FC Bucket Elevator Boots

Our elevator boots use a structural iron frame construction for solid support throughout the boot. All stiffeners and frames are powder coat finished before assembly for maximum corrosion resistance.

Bucket Elevator Boot Sections Include...

- Externally mounted pillow block bearings.
- Belt tension take-up screws utilizing corrosion resistant acme threaded rod.
- Machined, full length UHMW shaft seal at take-up plate bearing surface.
- Hinged boot inspection door on both sides.
- Heavy duty crown faced double disc drum pulley.
- Easy access cleanout doors on each end. Drop down design used on larger elevators.
- Removable panel at boot top, between trunks, can be adapted to dust collection equipment.
- Standard boot construction of heavy gauge steel and bolted structural angle iron frame with vertical stiffeners.



Farm-Com Trunking...

- 14 gauge steel bolted construction.
- Fixture welded, structural angle iron flanges are continuously welded on the outside and stitch welded on the inside.
- Maintenance friendly 10' (3048 mm) inspection section with 9' (2743.2 mm) long opening at both front and back. Front and back panels can be removed in 3' (914.4 mm) increments. The inspection door can be located in 6 different locations for ultimate flexibility.
- Unique bolted cross tie design provides rigidity, squareness to trunking and is independent of flange bolts.

Other Bucket Elevator Options:

- 12 gauge trunk construction.
- 1/4" (6.35 mm) expanded metal back urethane head housing and hood liners.
- Galvanized head service and distributor service platforms.
- Ladder and safety cage with rest platforms.
- Winged self cleaning boot pulley.
- Flared boot hopper.
- Standard boot hopper.
- Urethane lined head discharge transitions.
- Guy cable brackets.
- Factory assembled trunking.

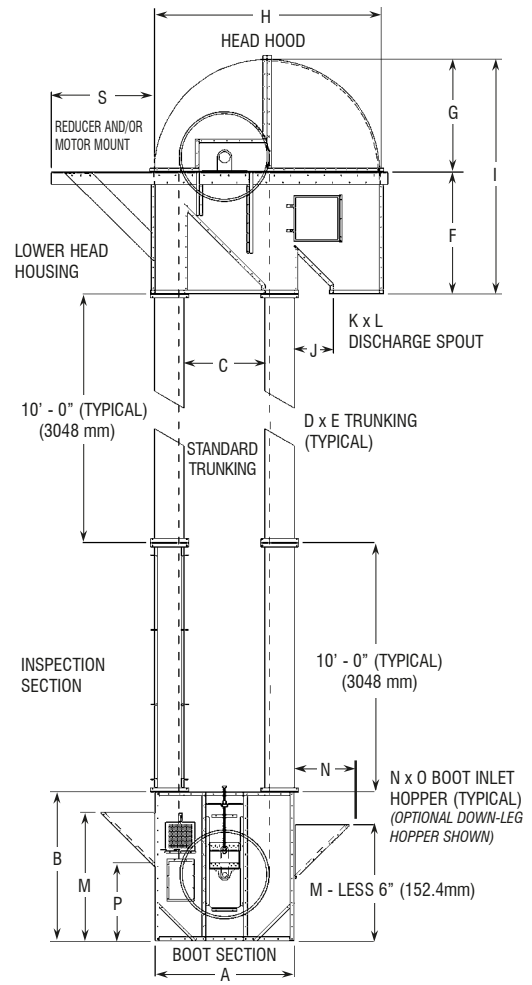

Dimensions

PULLEY SIZE	16	762	24	762	30	762	36	914
BPH	1500-3000	Metric	3000-5600	Metric	4000-8000	Metric	6000-10000	Metric
CFH	1875-3750	(mm)	3750-7000	(mm)	5000-7500	(mm)	7500-12500	(mm)
MTH	38-76		76-142		102-152		152-255	
A	34"	864	42"	1066	52"	1321	58"	1473
B	48"	1219	48"	1219	60"	1524	60"	1524
C	14"	356	22"	558	28"	711	34"	864
D	10"	254	10"	254	12"	305	12"	305
E	16"	406	16"	406	18"	457	18"	457
F	36"	914	36"	914	48"	1219	48"	1219
G	29"	737	33"	838	42"	1067	48"	1219
H	58"	1472	66"	1676	84"	2134	96"	2438
I	65"	1651	69"	1753	90"	2286	96"	2438
J	12"	304	12"	304	14"	356	20"	508
K	12"	304	12"	304	18"	457	18"	457
L	16"	406	16"	406	18"	457	18"	457
M	35"	889	42"	1067	46"	1168	53"	1346
N	14"	356	16"	406	16"	406	20"	508
O	10"	254	10"	254	12"	305	12"	305
P	21"	533	26"	660	30"	762	33"	838
S	30"	762	30"	762	40"	1016	40"	1016

FC Bucket Elevators Specifications

MODEL	BPH	CFH	MTH	PULLEY	RPM	FPM	M/S	BUCKET SIZE	BUCKET SIZE (MM)	BUCKET SPACING	BUCKET SPACING (MM)	TRUNKING SIZE	TRUNKING SIZE (MM)
15G16	1500	1875	38	16	95	423	2.15	9 x 5	228 x 127	9	228	10 x 16	254 x 406
20G16	2000	2500	51	16	95	423	2.15	9 x 5	228 x 127	7	178	10 x 16	254 x 406
25G16	2500	3125	63	16	95	423	2.15	9 x 6	228 x 153	8	203	10 x 16	254 x 406
30G16	3000	3750	76	16	95	423	2.15	9 x 6	228 x 153	.5	166	10 x 16	254 x 406
30G24	3000	3750	76	24	73	478	2.43	10 x 6	254 x 153	8	203	10 x 16	254 x 406
40G24	4000	5000	101	24	73	478	2.43	11 x 6	279 x 153	7	178	10 x 16	254 x 406
50G24	5000	6250	127	24	73	478	2.43	11 x 6 LP	279 x 153	5.5	140	10 x 16	254 x 406
56G24	5600	7000	142	24	73	478	2.43	11 x 6 LP	279 x 153	5	127	10 x 16	254 x 406
40G30	4000	5000	101	30	67	544	2.76	11 x 6	279 x 153	8	203	12 x 18	304 x 457
50G30	5000	6250	127	30	67	544	2.76	13 x 6	330 x 153	8	203	12 x 18	304 x 457
60G30	6000	7500	152	30	67	544	2.76	13 x 6 LP	330 x 153	6	153	12 x 18	304 x 457
60G36	6000	7500	152	36	64	620	3.15	11 x 7	279 x 178	8.5	216	12 x 18	304 x 457
70G36	7000	8750	177	36	64	620	3.15	13 x 7	330 x 178	9	228	12 x 18	304 x 457
80G36	8000	10,000	204	36	64	620	3.15	13 x 7	330 x 178	8	203	12 x 18	304 x 457
100G36	10,000	12,500	255	36	64	620	3.15	13 x 7 LP	330 x 178	6	153	12 x 18	304 x 457

Farm-Com Inclined Pit Conveyors

Inclined Pit Conveyor Features Include:

- Galvanized construction.
- Take-up assembly on the head for accessibility.
- Large profile UHMW paddles.
- 2.609" or 4" pitch roller bushed chain.
- 10 gauge center pan.
- Removable 8 gauge bottom.
- 10 gauge sides on 13" and 17" tall conveyor.
8 gauge sides on 21" tall conveyor.
- Head and tail slotted for shaft removal.
- Pillow block bearings head and tail.
- 1/4" UHMW shaft seals head and tail.



Optional welded bar grating with grain deflectors provided in 2' wide sections.

Optional bypass dump hopper includes internal screw adjustment for flow control.

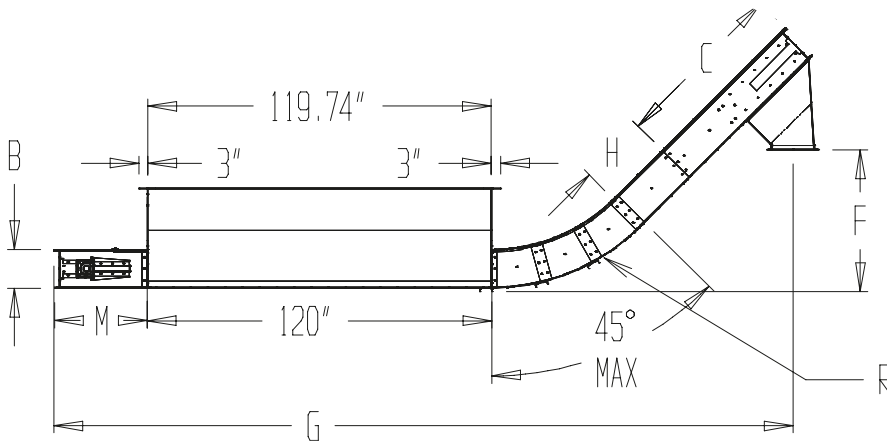
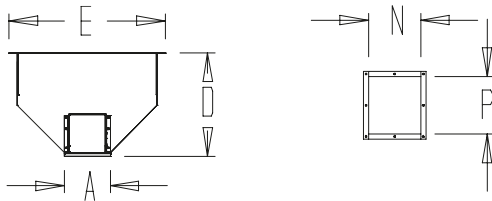

Model	Capacity BPH	FPM	RPM
9x9	1000	111	64
9x13	2000	139	64
13x13	3000	154	71
13x17	4000	148	48
15x17	5000	163	53
15x21	6000	153	39
15x21	7000	178	45
21x21	8000	152	39
21x21	10000	190	49

Farm-Com Inclined Pit Conveyor Specifications

MODEL	B.E.	A	B	C	D	E	F	G	H	M	N	P	R
9x9	10	12	10.75	60	28.625	50.5	36	315	12	32	10	13.5	69
9x13	16	12	14.75	60	28.625	50.5	35	269	12	32	11.5	8.75	73
13x13	16	16	14.75	60	36	54.5	35	261	12	32	11.5	9.625	73
13x13	24	16	14.75	60	36	54.5	42	273	24	32	13.5	9.625	73
13x17	24	16	18.75	60	36	54.5	42	276	24	32	13.5	9.625	77
13x17	30	16	18.75	60	36	54.5	46	272	24	32	13.5	12	77
15x17	24	18	18.75	60	34.75	54.5	42	285	36	32	13.5	9.625	77
15x17	30	18	18.75	60	34.75	54.5	46	281	36	32	13.5	12	77
15x21	30	18	22.75	60	34.75	54.5	46	284	36	32	13.5	12	81
15x21	36	18	22.75	60	34.75	54.5	53	281	36	32	17.375	12	81
21x21	36	24	22.75	60	36.75	54.5	53	290	48	32	17.375	12	81

¹ Galvanized construction with standard chain**, 10' bypass dump hopper, 45° bend section, 8 ga. bottom, and head discharge transition.

* General specifications and dimensions are subject to change without notice.

** Standard chain for 9", 13", and 17" tall conveyors is 2.609 pitch. For 21" tall conveyors, standard chain is 4" pitch.

Farm-Com Distributors

GSI's line of FC Distributors are galvanized for long life and minimum maintenance and come in many sizes and models for you to choose from.

Distributor Features:

- 3/16" and 12 gauge body parts. Outlets flanged.
- Located under the distributor is the positive locking stainless steel index plate which offers protection from dust and harsh weather conditions.
- Large throat on internal swing spout, bottom lined with 1/4" urethane for extended wear.
- Swing spout turns on a 1 1/2 " ball bearing, heavy-duty shaft connects to cable control.



Spring Loaded Latch Mechanism

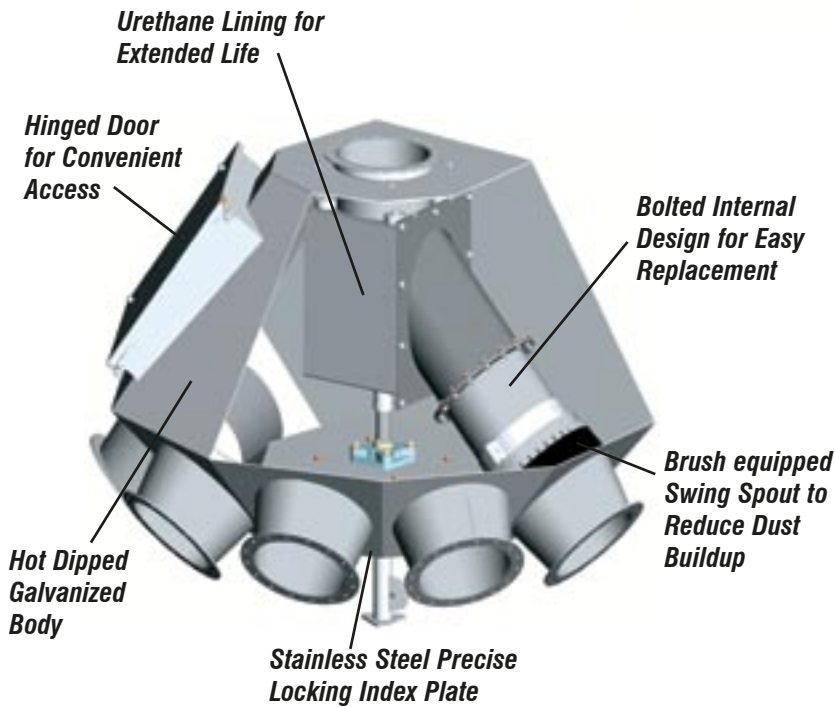
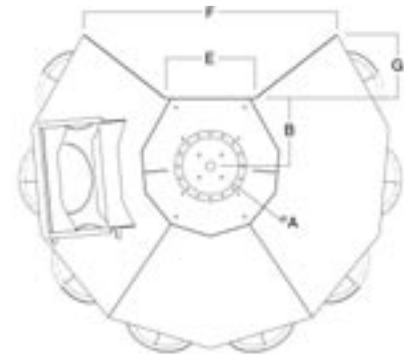
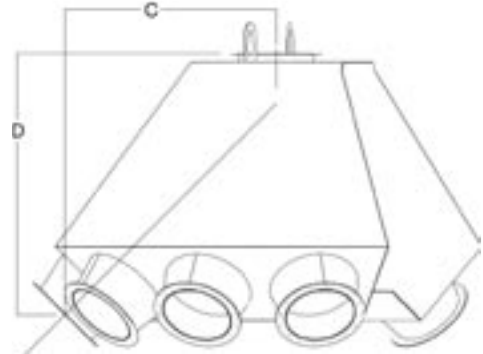

	4 Hole		6 Hole		8 Hole				10 Hole	
A	12"	8"	10"	12"	8"	10"	12"	14"	8"	10"
B	13-1/8"	11-1/8"	12-1/8"	13-1/8"	12-1/8"	12-1/8"	12-1/8"	12-1/8"	12-1/8"	12-1/8"
C	28-1/8"	21-13/16"	26-1/16"	28-1/8"	26-7/8"	29-13/16"	35-1/16"	40-5/16"	34-5/8"	40-3/8"
D	34-13/16"	30-5/8"	33-1/8"	34-13/16"	35-11/16"	36-15/16"	41-3/4"	48-7/8"	43-3/8"	47-1/2"
E	24-3/4"	42-9/16"	53-5/32"	59-5/16"	15-31/32"	15-15/16"	15-15/16"	15-15/16"	15-15/16"	15-15/16"
F	4 & 6 Hole - Flatback				36-3/8"	45-1/4"	61-7/8"	70-11/16"	56-3/16"	66-13/16"
G					3-13/16"	11-7/16"	11"	14-1/4"	10-7/16"	14-11/16"

FC Pit Conveyors & Distributors

Look for these other quality GSI Commercial products...



Series II Sweeps

- Class II, Group F and G, motor powers the heavy-duty helicoid auger flighting.
- 1 to 3 HP C-Face drive motor turns two 23" turf tires set in dual configuration.
- Simple to operate, Nema 4 control panel.
- Mounted Class II Speed Reducer for extra power.



Commercial Hopper Tanks

- 15' - 36' (4.57m - 10.97m) diameters.
- Holding capacities up to 58,000 BU. (1390 MT).
- Tank stiffeners directly supported by "wide-flange" beam columns.
- All galvanized hoppers with several slope options.
- Customized systems and seismic designs.



Grain Systems

"Your Complete Systems Manufacturer."

1004 East Illinois Street
 Assumption, Illinois 62510 USA
 Ph: 217-226-4421 • Fax: 800-800-5329
 Int'l Tel: 1-217-226-4401
 Int'l Fax: 1-217-226-3404
 Internet: <http://www.grainsystems.com>
 E-mail: gsisales@grainsystems.com



Commercial Bins/Silos

- Up to 105' (32m) diameter.
- Grain holding capacities exceeding 730,000 bushels (18,553 MT).
- 65,000 PSI high-strength stiffener columns.
- Solid "Wide-Flange" steel beam roof support system.
- High tensile/fully overlapping roof panels for maximum weather resistance.
- Sturdy sidewall ladders, ladder cages and platforms available for convenient bin access.
- Several floor options available including Cut-Lok, Cor-Lok and Post and Beam.



Rotamax Scalpers

- Capacities up to 60,000 BPH (1500 MTH) through a 1/2" screen.
- Much lower initial purchase cost.
- Low profile height and compact unit size.
- No vibration is used.
- Internal bypass is standard equipment.
- Low maintenance, very few moving parts.
- Urethane lining standard equipment.
- Gravity or rotary screener option available.
- Aspiration option available.

Z-Flow Screeners

- Sizes range between 3,500 and 21,000 BPH.
- Modular units combine to form larger screeners for easy future expansion.

Commercial Tower Dryers

- Drying capacities up to 10,000 BPH (254 MT).
- Sealed, large wet holding garner bin.
- Stainless steel, roll formed, exterior sheeting.
- Industrial quality components.
- Inside and outside safety ladders, cages and catwalks provide easy access.
- Walk-in cool and heat sections.
- Significant fuel savings by recycling heat.
- Patented discharge system provides simple, uniform metering and quick dryer clean out.
- 12" wide grain columns and long grain retention.
- Patented electronic monitoring control system mounted inside a NEMA IV fiberglass enclosure.
- Hopper bottom for efficient grain discharge and easy dryer clean out.