

**Q**Line

## Q-7900 Carriage House & Wind-Loaded Garage Door Opener System



Lifetime Parts  
Warranty



The Q-Line Carriage House Door System is a feature-rich, reliable system designed to perform, built to last and guaranteed to provide years of smooth, trouble-free operation. Its advanced 24 V digital operating system with Direct Current (DC) Smart Motor that, coupled with a belt drive system, ensures an amazingly quiet operation inside the garage.

**Marantec** 

Access Systems ▶ Automatically The Best Choice

Power	
Power Supply:	120V/60 Hz
Motor Voltage:	24V DC
Thermal Protection:	Automatic
Travel Rate-Main:	5.5 in./sec. approx.
Line Cord:	6ft. (3-Prong)
Push & Pull Force:	1000 Newtons
Powerhead Features	
Force adjustment:	Independent up/down if required
Logic Type:	Microprocessor with Built-In Surge Suppressor
Limit Settings:	Electronic
Low Voltage	
Connections:	Screwless
Display:	4-LED carousel
Radio Controls	
Frequency:	315MHz (HomeLink® compatible)
Technology:	Multibit code
Receiver:	Modular, wireless code learning
Digital Transmitters	
Included Transmitters:	(2) 2-channel MINI
Other Available Transmitters:	4-channel MINI 3-channel MICRO
Operating Range:	100 ft. approx.
Battery:	One 3V battery
Wired Controls	
Modular Multi-Function Wall Control with Vacation/LockSwitch	
Wireless Control (WKE)	
Personal Identifications Number (PIN):	4 Digit
Control:	3 Doors
Battery:	Two 3V batteries
Lighting System	
Time Controlled 3 bulbs, each 60W max.	
Lens Cover	
High impact, heat resistant, UL recognized plastic. 1 Lens Cover	

Safety and Convenience	
Safety:	Infrared photo eye protection system.
	Inherent reversal system (max. force and self learn).
	Limited to max. 30sec. run time
	Manual/emergency release.
	Flashing light during/after obstructed condition
Self Learn Force System:	Monitors and controls motor force every cycle (Smart Motor®) to optimize force requirements.
Soft Start/Soft Stop:	Electronically Controlled
Diagnostic System:	LED indicator
Warranty:	Lifetime on parts
Product Certification:	UL, C-UL, FCC, CSA, IC
Rail	
The best in advanced engineering and materials. These one piece, fully assembled drive systems are available with a steel-reinforced elastomer belt and 2mm High Strength finished steel C-rail.	
1 Piece, Galvanized Steel C-Channel preassembled:	10' 2-3/4"
System Length:	(overall for 7 ft. door) 10' 11-3/4"
Headroom	
Clearance:	1-1/4"
Trolley:	Includes emergency release, easy reconnect
Colors	
Rails and hardware is available in three colors: black, white, tan	



### Transmitters

Two styles of digital remote control transmitters in three different configurations. Unique, multi-bit technology, LED control button verification. 2-channel MINI (included). 4-channel MINI (optional) and 3-channel MICRO (optional) remotes for controlling other devices.

### Photo Eye Safety System

Advanced, infrared safety system. Inherent reversal system. Screwless terminal design for installation ease of pre-wired garages and standard/retrofit applications. Complies with all safety regulations.

### Modular Multi-Function Wall Station

Compact, stylishly designed to fit in a standard single gang electrical box. Illuminated push-button. Security vacationlock. Light control. Provides door operation and convenience from inside the garage. Individual control stations can be combined into one solid panel.

### Wireless Keyless Entry (WKE) System

Convenient, 4-digit PIN. Controls up to 3 different garage doors. Provide temporary access to authorized visitors or service personnel. Code security. Weather resistant.

### Modular Receiver

Innovative concept where the receiver module is simply plugged into the unit. This allows for quick and simple frequency changes to occur.

### Accessories

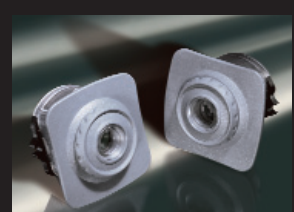

Marantec America Corporation  
675 Heathrow Drive • Lincolnshire, IL 60069  
p. 847.478.1500 • f. 847.478.0348



Access Systems ▶ Automatically The Best Choice

[www.marantecamerica.com](http://www.marantecamerica.com)